

FREZY KAŁOWE DOVETAIL CUTTERS ФРЕЗЫ УГЛОВЫЕ



7

DIN
1833
A/C

Z=8÷12

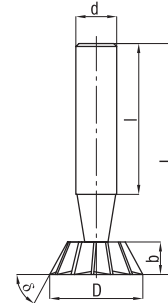

Form A – chwyt walcowy/ plain shank/ плоский хвостовик

δ	D (js16)	d (h8)	b (js14)	L (js18)	l	z	HSS	
							Code No 0641-573-	
45°	16	12	4	60	45	8	200102	●
45°	20	12	5	63	45	10	200907	●
45°	25	12	6.3	67	45	10	201500	●
45°	32	16	8	71	48	12	202250	●
50°	16	12	5	60	45	8	200204	●
50°	20	12	6.3	63	45	10	201001	○
50°	25	12	8	67	45	10	201602	●
50°	32	16	10	71	48	12	202262	●
55°	16	12	5.6	60	45	8	200306	●
55°	20	12	7.1	63	45	10	201103	●
55°	25	12	9	67	45	10	201704	●
55°	32	16	11.2	71	48	12	202274	●
60°	16	12	6.3	60	45	8	200408	●
60°	20	12	8	63	45	10	201205	●
60°	25	12	10	67	45	10	201806	●
60°	32	16	12.5	71	48	12	202288	●

Form C – chwyt walcowy z płaską/ flatted shank/ хвостовик с лыской

δ	D (js16)	d (h6)	b (js14)	L (js18)	l	z	HSS	
							Code No 0641-573-	
45°	16	12	4	60	45	8	210101	○
45°	20	12	5	63	45	10	210600	○
45°	25	12	6.3	67	45	10	211000	○
45°	32	16	8	71	48	12	211907	○
50°	16	12	5	60	45	8	210203	○
50°	20	12	6.3	63	45	10	210702	○
50°	25	12	8	67	45	10	211102	○
50°	32	16	10	71	48	12	212001	○
55°	16	12	5.6	60	45	8	210305	○
55°	20	12	7.1	63	45	10	210804	○
55°	25	12	9	67	45	10	211204	○
55°	32	16	11.2	71	48	12	212103	○
60°	16	12	6.3	60	45	8	210407	○
60°	20	12	8	63	45	10	210906	○
60°	25	12	10	67	45	10	211306	○
60°	32	16	12.5	71	48	12	212205	○